

USER MANUAL



Photo: © Håkan Maeland



by **femkes**

Getting started

Congratulations, you've bought a femkes rooftop! Please check if the following items are included when opening your box:

- 1 Mounting set, 8 bolts + self locking nuts, U-shape bars and a spanner
- 2 4 flexible poles to set up the fly tarp (fly tarp can be fully removed by a zipper)
- 3 Standard 2.3 m ladder with horizontal steps for easy access (2.6 m ladder optional per request)
- 4 Hooks inside the shell for your bag(s) to store your personal belongs overnight
- 5 Original 'by femkes' zipper pullers, for cold hands and easy closing of the zippers
- 6 3d mesh underneath the mattress for better ventilation
- 7 Bags for shoes, accessories and your roadmaps

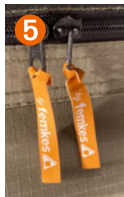
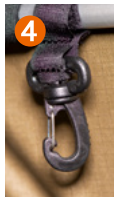

How to mount your rooftop tent

- Open the box
- Remove cardboard and foam
- Place your JoyCee on the cross bars of your car
- Centre JoyCee on top of your car
- Insert two square-head bolts or sliders into the front of the rail
- 1 Lift the tent and slide over the cross bar
- 2 Insert second bolt
- Step and repeat for the back of the rail
- 3 Add the brackets to the bolts
- 4 Connect the nuts but not too tight yet
- Check if tent is centred properly
- Use the spanner to tighten the nuts, front first
- Then tighten the nuts on the back of the rail

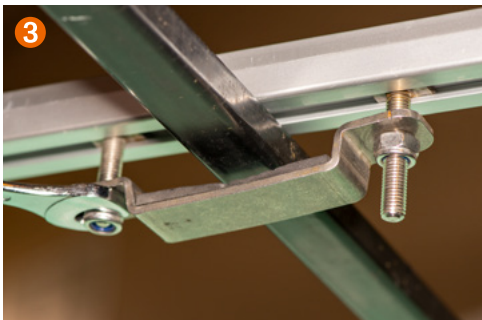
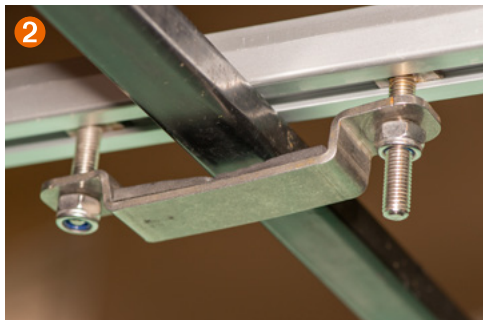
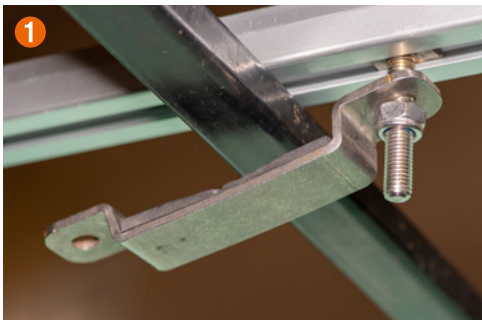

IMPORTANT

- Tighten the two bolts simultaneously per cross bar
- Don't tighten too far,
- The bracket needs to stay horizontal and shouldn't bend
- Keep all aluminium parts, bolts and nuts clean and double check all bolts
- Check again after the first 100 kms of driving
- Repeat regularly
- Keep all screws and bolts clean and serviced with WD40

Opening your hardshell tent

- Unlock the velcro straps
- Unlock the reinforced straps
- Push up the shell (the gas struts make this easy)
- Install the 2 brackets to the bottom of the tent on your favourite entry side, using the pre-drilled holes in the bottom plate
- Remove the ladder from your tent
- Remove the bag of the ladder and keep this bag dry and clean at all times
- Undo the velcro strap (first time only)
- Pull out the ladder all the way
- Hang the ladder in the brackets, hold the top steps and pull out the steps needed to reach the ground
- Securely install the ladder to the right height
- Make your bed and note that you can leave your pillows inside. Leave bedding as flat as possible when closing the shell.

OPERATION OF THE LADDER

CAUTION! Failure to properly secure the ladder could cause serious injury. Read the next steps carefully before attempting to use the ladder.

- Depending on the height of your car, hold 3-4 rungs at the top and pull out the bottom rungs until they reach the ground
- If you have a low car, you might need to hold 5 rungs. If you are on a high car, you only might need to hold 2 rung or less
- It is also possible to lock the steps by half a rung
- Make sure the ladder is placed on even, solid ground. Do not install the ladder on uneven or sandy/muddy ground
- Place the ladder firmly at an approximate 70 degrees angle
- The ladder should not be installed and used in a vertical position, always at a slight angle for better support
- Before entering the tent, check if every rung is secured. Use two hands to climb up, one step at the time



Setting up your bedroom

- The fly tarp needs to be set up by at least 2 poles next to the big entrance, 1 pole on each side.
- Climb halfway up the ladder, insert the flexible poles horizontally into the holes on both sides of the ladder, through the small 'envelopes' in the fabric
- The hook of the flexible poles should be looking down, hold the pole with one hand
- Use the other hand to grab the top of the fly tarp and insert the pole into the O-ring overhead in both corners of the fly tarp
- Connect the tips of the fly tarp to the tent, by zipper or velcro
- 1 Continue with the (2 per side) remainder of the flex poles to position the fly tarp in the open mode by following the previous steps again on both sides of the tent. Please note that some holes are horizontal but the poles need to be entered at an angle

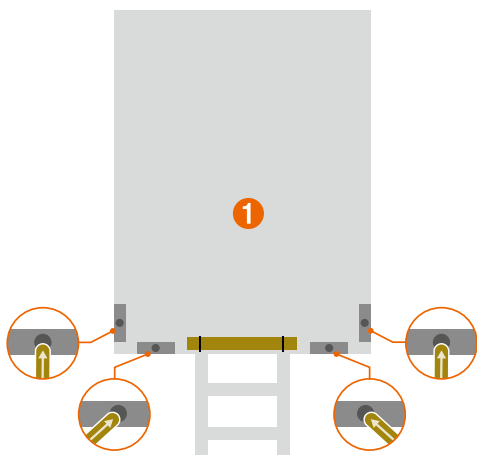

Closing the hardshell tent

- Flatten your sleeping bags and pillows in the tent
- Remove the ladder from the brackets
- Shorten the ladder and place the ladder back in the dry and clean storage bag
- Take the elastic strap from the far left of the outside of the tent, over the tent and connect to the same loop on the right of the tent, this will help when pulling the tent shut
- Pull the black nylon strap down which is attached to the shell and will close the tent
- Tuck the fabric sticking out into the tent on both sides and the front, don't forget to also push the nylon strap under the shell
- Use the velcro straps to tighten the shell, once closed use the reinforced straps to secure the tent
- If you have difficulties closing the shell, you may have left too much bedding in the tent. In this case, remove the bedding and try again
- Use your flat hand on top of the shell to pull the shell down. Don't pull at the locks or rubber band

2 different positions



Open

For extra shadow and a breeze

In this position it is possible to add the optional zip-on annex awning to the fly tarp. The fly tarp can also be removed completely by a zipper under the shell.



Closed

In case of lots of wind

The fly tarp can be made smaller by closing the zipper on both sides or by the velcro on the fabric. In this position you can still enjoy the view but the JoyCee will catch less wind and rain.

Tips and tricks

Some of our tips and tricks:

- 1 Extra elastic strap for easy closure, be careful not to let go if you are setting up up together, it will hurt
- 2 RVS plates for extra strength and depth for the flex poles, push deep, you'll hear a 'click' when you reach the end
- 3 Please note, the holes for the flex poles are at an angle and poles must be pushed in horizontally at the right angle for stability of the fly tarp

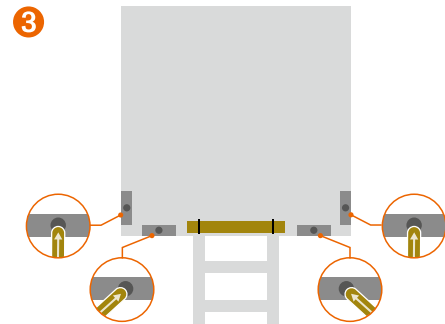
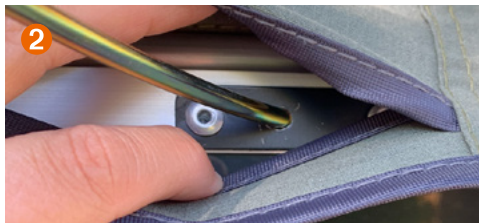

- 4 We have added a small rubber ring to the flex poles, this will ensure that raindrops will fall down at the ring instead of making the fabric of your tent wet
- 5 JoyCee offers the option to enter the tent on all 3 sides. Only one set is provided, an extra set can be bought for entry on 2 sides
- 6 Three bags are included, 2 for shoes and accessories which you can hang outside the tent and 1 long one for inside the tent. Extra bags can be bought if required.



Accessories & maintenance

To upgrade your tent, we offer the following:



Optional zip-on awning with 4 telescopic poles



Storage protection cover



Anti-theft set of nuts and bolts M8



Extra ladder brackets available for multiple entry points

Maintenance

Your tent also needs maintenance, just like your car. Some love and care will help longevity.

- Always make sure the fabric of the tent and the mattress is dry before long term storage
- Always ventilate well, also in moist weather. Ventilation is important at all times
- Keep all stainless steel and aluminium parts clean and spray them with WD40 regularly
- The shell can also be cleaned with a soft cloth. For a nice shine or for extra UV protection we recommend 303 aerospace UV protectant spray

More questions?

Please ask your local reseller

WARNING

- The rooftop tent needs to be mounted and connected to roofbars or roof rack prior to climbing into the rooftop tent
- If you have any back, knee or other health issues, do not attempt to climb the tent on top of your vehicle
- The crossbars must have a dynamic weight load of minimum 55 kg and must be at least 70 cm apart
- Under no circumstances should any flame sources be used inside the tent
- When camping, keep a safe distance with open fires in order to avoid airborne burning embers
- Open the zippers by using the pullers, not by pulling or tearing at the fabric

by **femkes**
femkesrooftop tents.com

WARRANTY: We offer a 2 year warranty on the femkes rooftop tents. Warranty does not apply on zippers and other closures. Warranty does not apply for damage to the tent caused by any of the weather elements, wind or rain. Warranty does not apply caused by improper usage of the tent, i.e. forgetting to remove the rods from the gas struts inside the tent. Note: the recommended speed limit when driving with a rooftop tent on your vehicle is 120 km/h. Your driving speed should be adjusted according to the driving conditions, such as road type and road quality, weather (wind, rain or snow) and applicable speed limits. Decrease your speed for speed bumps and on bumpy roads.